

# INCA SMART SS HALOGEN

body components

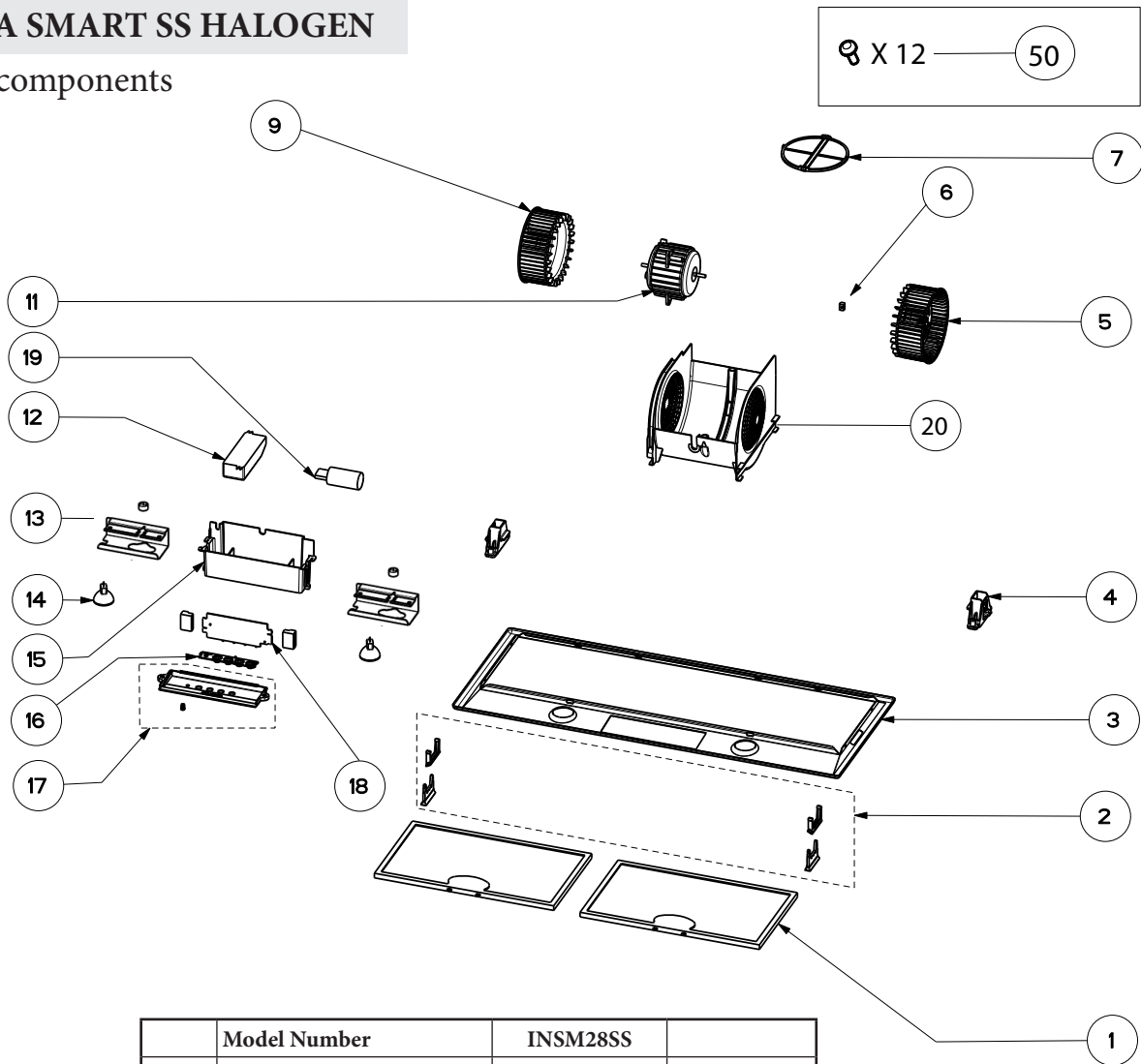

Key	Model Number	INSM28SS	Qty Req.
1	Grease filter	133.0064.533	2
2	Support latch kit	133.0064.071	2
3	Filter support frame	133.0066.980	1
4	Mounting bracket kit	133.0017.051	1
5	Right Impeller (DX)	133.0060.910	1
6	Motor rubber kit (5 in kit)	133.0016.966	1
7	Damper	133.0056.177	1
9	Left Impeller (SX)	133.0060.909	1
20	Motor ( <i>made before 2014</i> )	133.0064.543	1
20	Motor ( <i>Serial # starts 4, 5, 6</i> )	133.0184.469	1
12	Transformer	133.0174.154	1
13	Lamp holder	133.0056.189	2
14	Halogen Lamp	133.0046.418	2
15	Switch support box	133.0184.468	1
16	Switch button kit	133.0078.943	1
17	Switch box cover kit	133.0184.466	1
18	Switchboard	133.0184.467	1
19	Capacitor	133.0068.611	1
20	Blower motor Housing	133.0016.931	1
50	Mounting Kit Screws Inca	133.0084.481	1